

## 2008 DYNA 51' Standard Specification List

ITEM	<b>GENERAL SPECIFICATION</b>	
1.	LENGTH OVERALL	1 5.55M (51')
2.	BEAM MAX	4.45M (14'-6")
3.	DRAFT UNDER PROPELLERS	1.27M (4'-2")
4.	HEIGHT ABOVE WATER LINE TO TOP OF MAST	5.01M (16'-5")
5.	APPROX. DISPLACEMENT	17500KGS (38580LBS)
6.	FUEL CAPACITY	1892L (500 US GALS)
7.	FRESH WATER CAPACITY	454L (120 US GALS)
8.	SLEEPING ACCOMODATION	4 ~ 8P
9.	Engine Options: CAT-C7(460HP) / C9(510HP) VOLVO-D9(500HP, 575HP) / IPS500(370HP) / IPS600(435HP)	
10.	ONAN GENERATOR 13.5KW/60HZ (11KW/50HZ)	
11.	MARINE AIR AIRCONDITIONER W/REVERSE CYCLE HOT & COLD TOTAL 34,000BTUs	
	<b>HULL FORM AND CONSTRUCTION</b>	
1.	DEEP V HULL BOTTOM	
2.	ALL FIBERGLASS THROUGHOUT THE BOAT LAID UP BY HAND	
3.	FOAM CORE CONSTRUCTION ABOVE WATER LINE	
4.	SOLID FIBERGLASS CONSTRUCTION BELOW WATER LINE	
5.	EXTENSIVE NETWORK OF TRANSVERSE AND LONGITUDINAL STRINGERS GLASSED IN THE HULL BOTTOM	
6.	INTERIOR OF HULL BOTTOM PAINTED OUT IN GELCOAT	
7.	DECK SIDES ARE FOAM CORE CONSTRUCTION	
8.	CABIN TOPS ARE BALSAM CORE CONSTRUCTION	
9.	THE HULL AND DECK ARE BOLTED AND FRP BONDED TOGETHER	
10.	MOULDED NON-SLIP DECK SURFACE	
11.	ANTIFOULING	
12.	LAMINATION WITH VINYLESTER RESIN TO PREVENT OSMOSIS	
	<b>DECK FITTING</b>	
1.	REVERSIBLE ELECTRIC LOFRANS WINDLASS WITH REMOTE CONTROL FROM BOTH HELM AND DIRECT CONTROL ON THE FORE DECK	
2.	STAINLESS STEEL ANCHOR 45LBS & 50M GALVANIZED CHAIN	
3.	FLAG POLE SOCKET	
4.	STAINLESS STEEL BOW ROLLER	
5.	STAINLESS STEEL CHAINWAY & CHAIN LOCKER	
6.	STAINLESS STEEL TWIN BOW, SPRING AND STERN CLEATS	
7.	STAINLESS STEEL PULPIT & SIDE HAND RAIL	
8.	FRAMELESS WINDOWS IN TEMPERED GLASS DIRECTLY MOUNTED AND SEAL ON FRP	
9.	HEAVY DUTY RUBBER WITH STAINLESS STEEL RUBRAIL	
10.	WATER AND FUEL FILLERS	
11.	FORE DECK ROUND ESCAPE HATCH	
12.	FWD DECK SUN LOUNGE PAD	
13.	STAINLESS STEEL OPENING PORTHOLES WITH SCREENS	
14.	FRP STAIRS TO FLYBRIDGE WITH STORAGE UNDERNEATH	
15.	WATERPROOF STEREO SPEAKERS	
16.	COCKPIT FRP SEAT WITH CUSHION AND STORAGE UNDERNEATH	
17.	COCKPIT HATCH TO LAZARETTE WITH S/S LADDER	
18.	ACCESS DOOR FROM LAZARETTE TO ENGINE ROOM	

19.	SELF DRAINING
20.	STEPS TO SIDE DECKS
21.	COCKPIT CEILING LIGHTING
22.	SHORE POWER INLET
23.	MANUAL BILGE PUMP WITH CHEST VALVE IN LOCKER
24.	TRANSOM DOOR DOWN TO SWIMMING PLATFORM
25.	TRANSOM SHOWER HOT AND COLD
26.	SWIMMING PLATFORM AND CONCEALED STAINLESS STEEL LADDER
27.	TEAK LAID ON SWIMMING PLATFORM AND COCKPIT
28.	TRIM TABS W/ INDICATORS
	<b>FLYBRIDGE AND SECOND HELM POSITION</b>
1.	STAINLESS STEEL HANDRAILS WITH ACRYLIC WINDSHIELD
2.	FLYBRIDGE FRP INSTRUMENTS BOARD WITH BURL PANEL AND ACRYLIC COVER
3.	HYDRAULIC STEERING SYSTEM AND STEERING WHEEL
4.	MORSE KE-4 ELECTRONIC ENGINE CONTROLS
5.	START/STOP ENGINES KEYS
6.	ENGINE RPM GAUGES
7.	ENGINE COOLING WATER TEMPERATURE GAUGES
8.	ENGINE OIL PRESSURE GAUGES
9.	AUDIBLE AND VISUAL ENGINE ALARM
10.	BILGE PUMP AUDIBLE ALARM
11.	REMOTE WINDLASS CONTROL
12.	SEARCH LIGHT WITH REMOTE CONTROL
13.	COMPASS AND MARINE HORN
14.	RUDDER INDICATOR
15.	INTERCOM
16.	2 SWIVEL HELM SEATS
17.	WET BAR W/ CABINET FOR ICE MAKER OR STORAGE (NOTE: ICE MAKER IS OPTION)
18.	CURVATURE SETTEE WITH CUSHION AND FRP TABLE
19.	ACCESS HATCH FROM COCKPIT BY FRP STAIRSWAY
20.	RADAR ARCH
21.	INTERNATIONAL NAVIGATION LIGHTS
22.	WATERPROOF STEREO SPEAKERS UNDER THE RADAR ARCH
23.	FLAG POLE SOCKET
24.	FRP NONSKID FLOOR
25.	SELF DRAINING
	<b>LOWER MAIN HELM</b>
1.	LEATHER HELM SEAT FOR 2 PERSONS
2.	BURL INSTRUMENT PANEL
3.	NAVIGATION SWITCHES PANEL
4.	DC & AC CONTROL PANELS
5.	REPEATED ENGINE CONTROLS & INSTRUMENTS
6.	REPEATED STEERING SYSTEM & STEERING WHEEL
7.	WINDLASS CONTROL
8.	SEARCHLIGHT CONTROL
9.	RUDDER INDICATOR
10.	TRIM TAB INDICATORS
11.	COMPASS AND HORN BUTTON
12.	INTERCOM
16.	ENGINE ROOM EXTINGUISHING AND AUTOMATIC SHUT DOWN SYSTEM
17.	WINDSCREEN WIPERS WITH FRESH WATER WASH SYSTEM

	<b>INTERIOR</b>
1.	PLYWOOD CABIN SOLE THROUGHOUT WITH CARPET ( EXCEPT GALLEY )
2.	CHOICE OF WOOD VENEER ON SIDES AND BURL WOOD COUNTER TOP (STANDARD TEAK, MAPLE OR CHERRY VENEER AND CAMPHOR BURL TOP)
3.	CHOICE OF UPHOLSTERY FABRICS FOR CURTAINS , DRAPES AND BED MATTRESS COVERS IN SALON AND ALL CABINS (OPTIONAL PILLOWS AN D BEDSPREADS)
4.	VINYL HEAD LINERS AND LEATHER SEATINGS
5.	JOINERY AND WOODWORK SUPERBLY FINISHED IN HIGH GLOSS
6.	STANDARD TWO CABINS WITH GALLEY + DINETTE DOWN LAYOUT
7.	VIMAR SWITCHES AND OUTLETS
8.	GROHE SHOWER FITTINGS
9.	GFI OUTLETS IN CABIN HEADS AND GALLEY AREA
	<b>MAIN SALOON</b>
1.	CANTALUPI CEILING HALOGEN LIGHTINGS
2.	STEREO CD PLAYER WITH 2 SPEAKERS
3.	ENTERTAINMENT CABINET WITH TV PRE -WIRING
4.	BAR WITH ICE MAKER AND LIQUOR CABINET
5.	L-SHAPED LEATHER SETTEE AND TABLE
6.	CONCEALED TUBE LIGHTINGS UNDENEATH SOFAS AND ON CEILING A/C VENTS
7.	BENCH SEATING FOR 3, OPPOSITE
8.	ACCESS STAIRS TO LOWER DECK WITH LIGHTED STEPS
9.	CEILING LINED WITH SYNTHETIC LEATHER
10.	CARPET FLOORING WITH ACCESS TO ENGINE ROOM
11.	SILDING DOOR TO COCKPIT
12.	SWITCHES, POWER SOCKETS, VOLUME & AIR CONDITIONG CONTROL
	<b>GALLEY &amp; DINETTE-DOWN (OPTIONAL GALLEY-UP OR DINETTE UP)</b>
1.	REFRIGERATOR WITH DUAL VOLTAGE
2.	SINKS WITH HOT AND COLD MIXER FAUCET AND CHOPPING BOARD COVER
3.	ELECTRIC COOKER W/ 3 BURNERS
4.	EYE LEVEL MICROWAVE
5.	EXTRACTOR FAN ABOVE COOKER
6.	TRASH BIN
7.	EYE LEVEL CABINET AND WATER GAUGE
8.	DRAWERS FOR STORAGE
9.	OPENING PORTHOLE
10.	DINETTE LEATHER SETTEE FOR 4 WITH HI-LO TABLE
11.	GRANITE COUNTERTOP
12.	TEAK AND HOLLY FLOORING
	<b>FWD MASTER CABIN</b>
1.	QUEEN SIZE BERTH WITH STORAGE UNDER NEATH
2.	TWIN DRESSING TABLES AND DRAWERS
3.	HANGING LOCKER WITH LIGHT
4.	ROUND ESCAPE HATCH TO FOREDECK
5.	MIRROR BACK WALLS WITH TWO READING LIGHTS
6.	HALOGEN CEILING LIGHTINGS, SWITCHES & POWER SOCKETS
7.	2 SPEAKERS CONNECTED FROM SALOON STEREO CD
8.	OPENING PORTHOLES (4)
9.	INTERCOM AND TV PREWIRING
10.	VOLUME & AIRCONDITIONING CONTROL
11.	PRIVATE ACCESS TO MASTER HEAD

	<b>MASTER'S HEAD</b>
1.	DIRECT ACCESS FROM MASTER CABIN
2.	MEDICINE CABINET W/MIRROR
3.	VACUFLUSH MARINE TOILET W/HOLDING TANK FOR SEA/DOCKSIDE DISCHARGE
4.	WASH BASIN WITH HOT AND COLD WATER MIXER FAUCET
5.	GRANITE COUNTERTOP
6.	HOT AND COLD SHOWER WITH AUTOMATIC PUMP OUT
7.	INDEPENDENT STALL OR ROUND S SHOWER ROOM WITH DOOR
8.	CHROME SHOWER FITTINGS AND TEAK GRATES IN SHOWER ROOM
9.	TOWEL HOLDER
10.	TOILET ROLL HOLDER
11.	OPENING PORTHOLE
12.	EXTRACTOR FAN
	<b>PORT CABIN</b>
1.	2 SINGLE 6'-4" BERTH (OR DOUBLE BERTH AVAILABLE)
2.	HANGING LOCKER W/ LIGHT
3.	NIGHTSTAND W/ DRAWER
4.	READING LIGHTS
5.	HALOGEN LIGHTINGS, SWITCHES & POWER SOCKETS
6.	STEREO SPEAKERS CONNECTED FROM SALOON
7.	OPENING PORTHOLES
8.	INTERCOM
9.	PRIVATE ACCESS TO GUEST'S HEAD
	<b>GUEST'S HEAD</b>
1.	ACCESSIBLE FROM THE PORT CABIN AND THE CORRIDOR
2.	MEDICINE CABINET W/ MIRROR
3.	VACUFLUSH MARINE TOILET W/ HOLDING TANK FOR SEA/DOCKSIDE DISCHARGE
4.	WASH BASIN WITH HOT AND COLD WATER MIXER FAUCET
5.	GRANITE COUNTERTOP
6.	HOT AND COLD SHOWER W/ AUTOMATIC PUMP OUT
7.	CHROME SHOWER FITTING
8.	TOWEL HOLDER
9.	TOILET ROLL HOLDER
10.	EXTRACTOR FAN
11.	OPENING PORTHOLE
	<b>ENGINE COMPARTMENT AND LAZARETTE</b>
1.	ACCESSIBLE FROM THE COCKPIT AND THE SALOON
2.	WATER COOLED ENGINE EXHAUST UNDER WATER AND BY-PASS OUTLETS ABOVE WATER AT TRANSOM
3.	EXHAUST BLOWERS W/ TUBING
4.	RACOR FUEL/WATER FILTERS
5.	LEAD FOAM ENGINE ROOM SOUND INSULATION
6.	ENGINE ROOM LIGHTING
7.	ALUMINIUM FUEL TANK W/ SEPARATE FILLERS AND VENTS
8.	HIGH CAPACITY ELECTRICAL BILGE PUMPS W/ FLOAT SWITCHES (3)
9.	ENGINE ROOM FIRE EXTINGUISHING SYSTEM WITH AUTOMATIC ENGINE SHUT DOWN
10.	ARMCO AQUAMET SHAFTS WITH DRIPLESS SHAFT SEALS
11.	4 BLADE MN-BZ PROPELLERS
12.	BRONZE STRUTS
13.	STAINLESS STEEL RUDDERS WITH STAINLESS STEEL POSTS
14.	AIR-CONDITIONING COMPRESSING UNITS
15.	MAIN GENERATOR IN LAZARETTE

16.	FRP NONSKID FLOORING
17.	COLOR CODED PLUMBING SYSTEM
18.	WATERTANK IN LAZARETTE AND ACCESS DOOR TO ENGINE ROOM
19.	WATER HEATER IN LAZARETTE
	<b><i>ELECTRICAL SYSTEM</i></b>
<b><i>(A)</i></b>	<b><i>12V SYSTEM</i></b>
1.	TWO 200 AH BATTERIES WIRED IN PARALLEL SUPPLY THE DOMESTIC SERVICE AND ACCEPT CHARGE FROM BATTERY CHARGER OR ENGINE
2.	TWO 200 AH BATTERIES START BOTH ENGINE AND CHARGED BY ENGINE OR BATTERY CHARGER
3.	ONE 100 A.H. BATTERY FOR GENERATOR START
4.	DC LIGHTING THROUGHOUT
5.	BATTERY MASTER SWITCH AT MAIN SWITCH PANEL
6.	CIRCUIT BREAKERS ON ALL CIRCUITS
7.	BONDING SYSTEM W/ZINC PLATES
<b><i>(B)</i></b>	<b><i>120V SYSTEM (240V AVAILABLE)</i></b>
1.	SHORE POWER INLET AT COCKPIT
2.	MASTER DC AND AC CIRCUIT BREAKER PANELS IN THE SALOON
3.	AC CIRCUIT BREAKERS ON ALL CIRCUITS
4.	SPARE CIRCUIT BREAKERS ARE PROVIDED FOR OPTIONAL EQUIPMENT
5.	AC OUTLETS THROUGHOUT
6.	COLOR CODED WIRING SYSTEM
	<b><i>WATER SYSTEM</i></b>
1.	STAINLESS STEEL WATER TANK W/FILLER AND SHORE WATER CONNECTION
2.	12 GALS WATER HEATER W/HEAT EXCHANGER
3.	AUTOMATIC WATER PRESSURE PUMP FOR HOT AND COLD WATER
4.	HOT AND COLD WATER SYSTEM TO ALL HEADS/GALLEY/COCKPIT
5.	COLD WATER SYSTEM TO ENGINE ROOM AND FLYBRIDGE
6.	ALL THRU-HULL WITH SEACOCKS
7.	ANCHOR CHAIN WASHDOWN SYSTEM (SEA WATER)
8.	AFT DECK WASH DOWN
9.	SEA WATER STRAINERS
10.	SUMP TANK W/PUMP

*Since we strive for continuous improvement, this specification list is subject to change without notice.*

LOA	LWL	BEAM	DRAFT	OWNER
50'-7-1/4"	40'-6-1/2"	14'-7"	2'-4-1/2'	

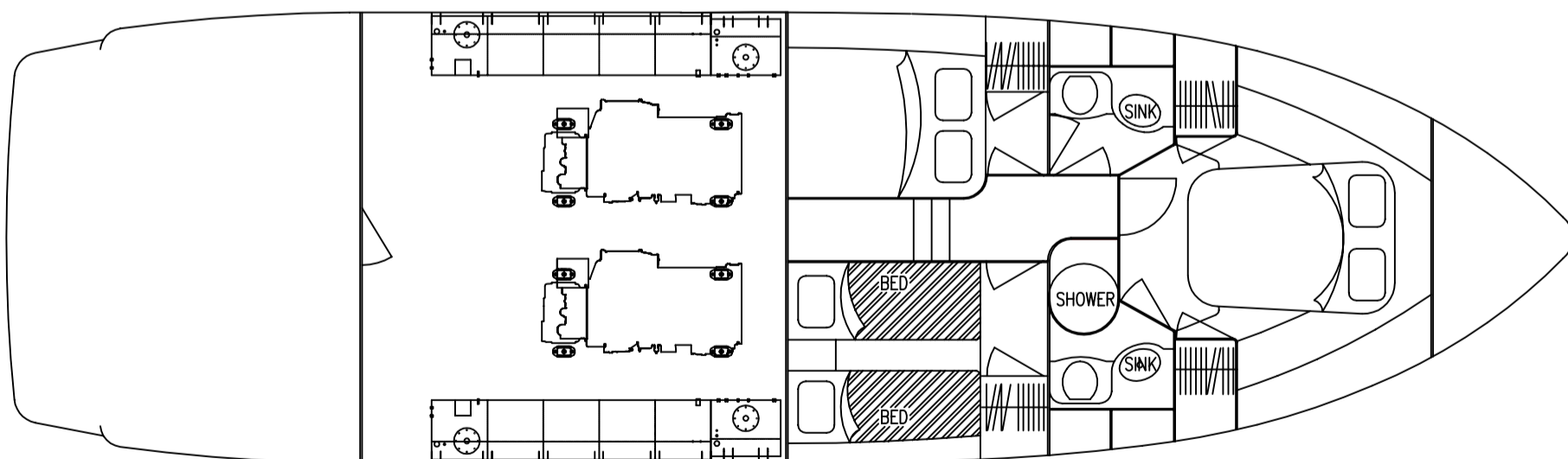
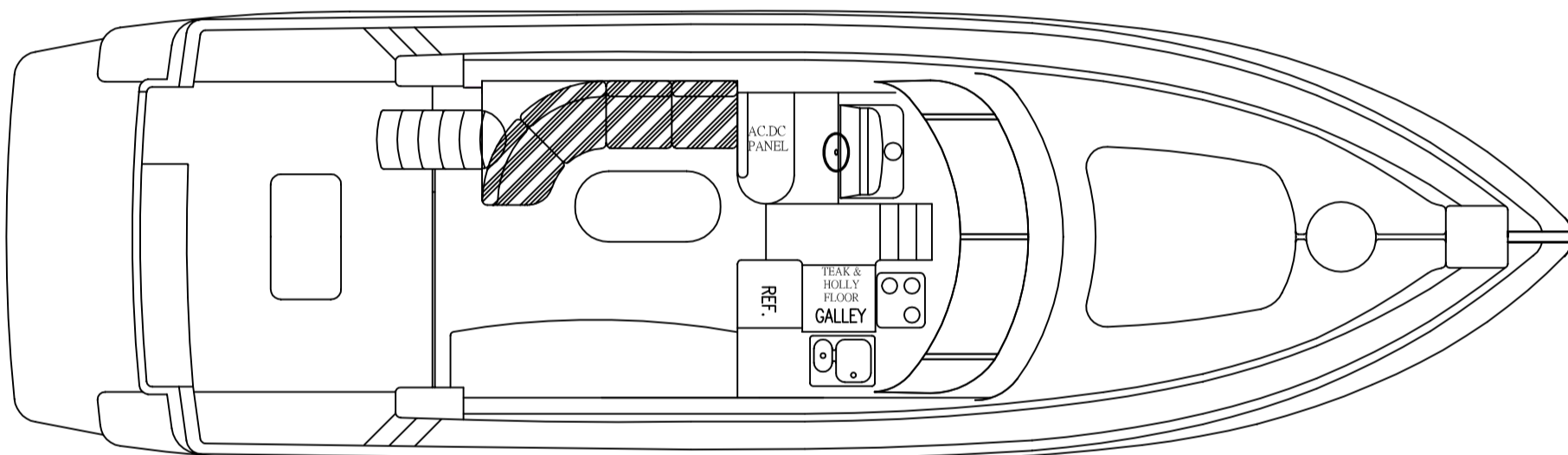
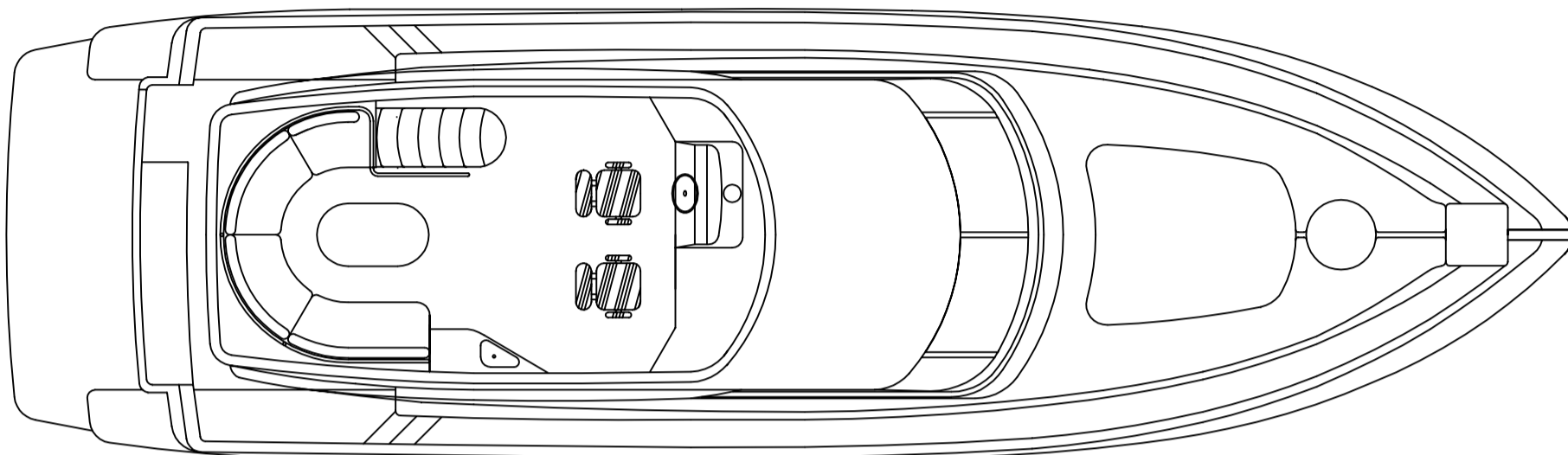

<b>Dyna 51'</b>	BOAT NO.	DW'G NO	SCALE	DATE	DW'N BY	DS' BY	VERIFY
General Layout	Type B	D51G01-B	3/16":1'	2007/08/23	Linjs		

LOA	LWL	BEAM	DRAFT	OWNER
50'-7-1/4"	40'-6-1/2"	14'-7"	2'-4-1/2'	

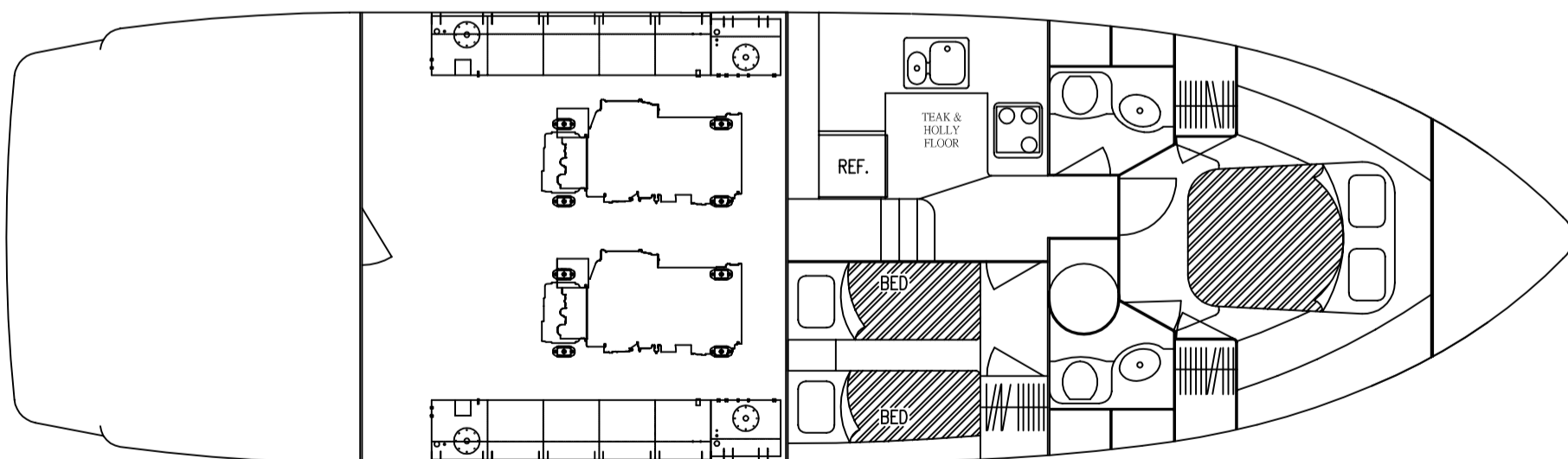
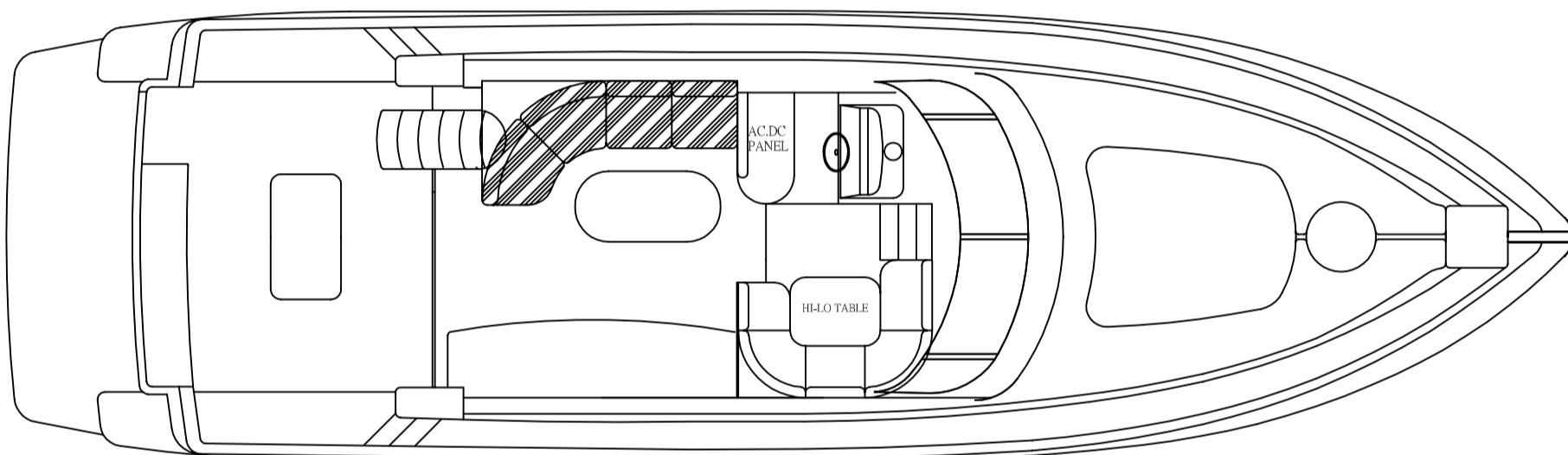
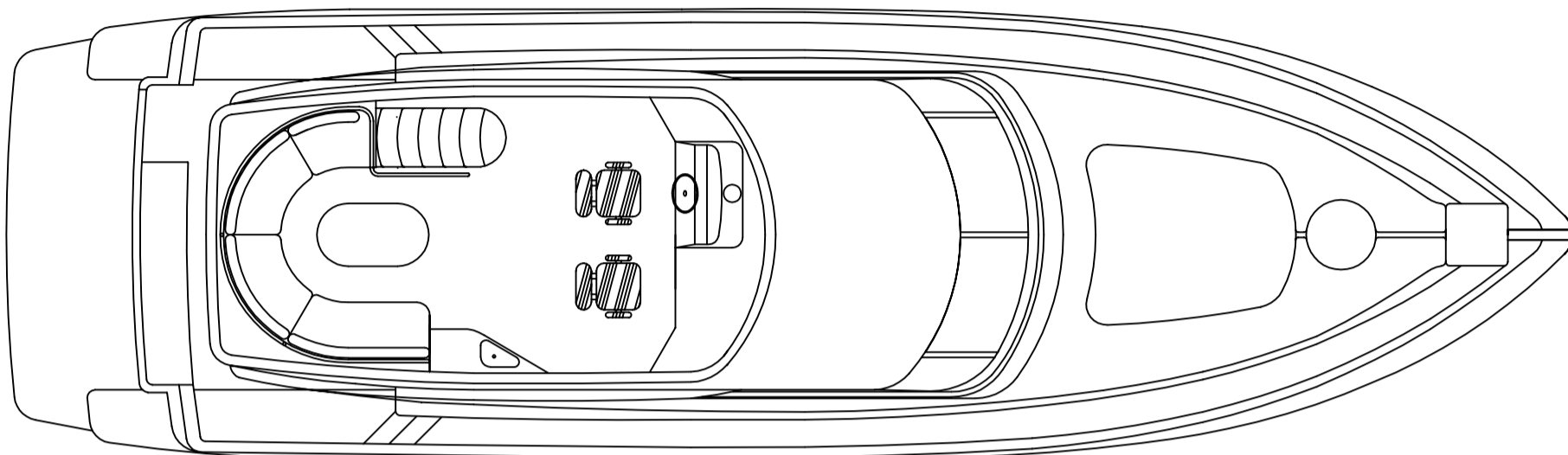

<b>Dyna 51'</b>	BOAT NO.	DW'G NO	SCALE	DATE	DW'N BY	DS' BY	VERIFY
General Layout	Type C	D51G01-C	3/16":1'	2007/08/23	Linjs		

LOA	LWL	BEAM	DRAFT	OWNER
50'-7-1/4"	40'-6-1/2"	14'-7"	2'-4-1/2'	

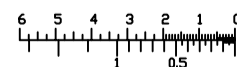
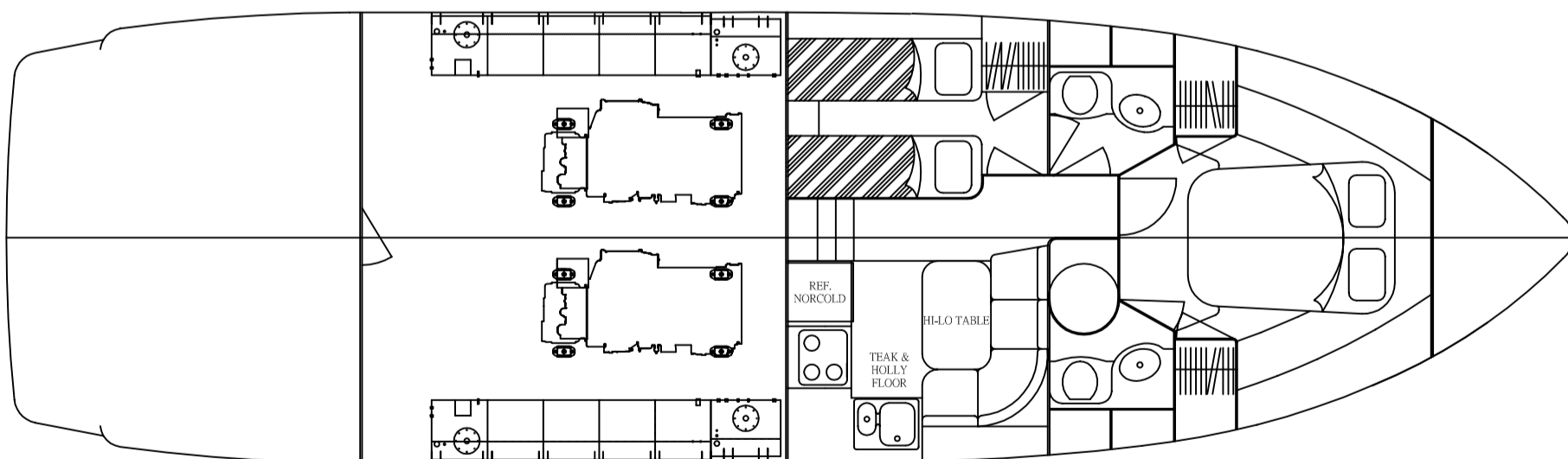
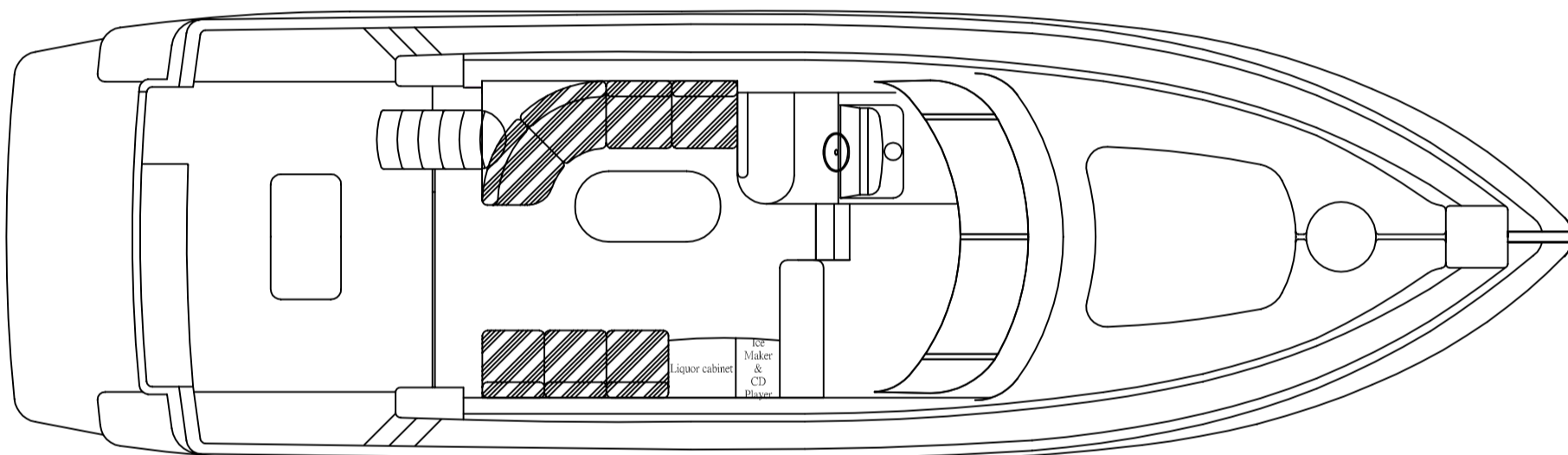
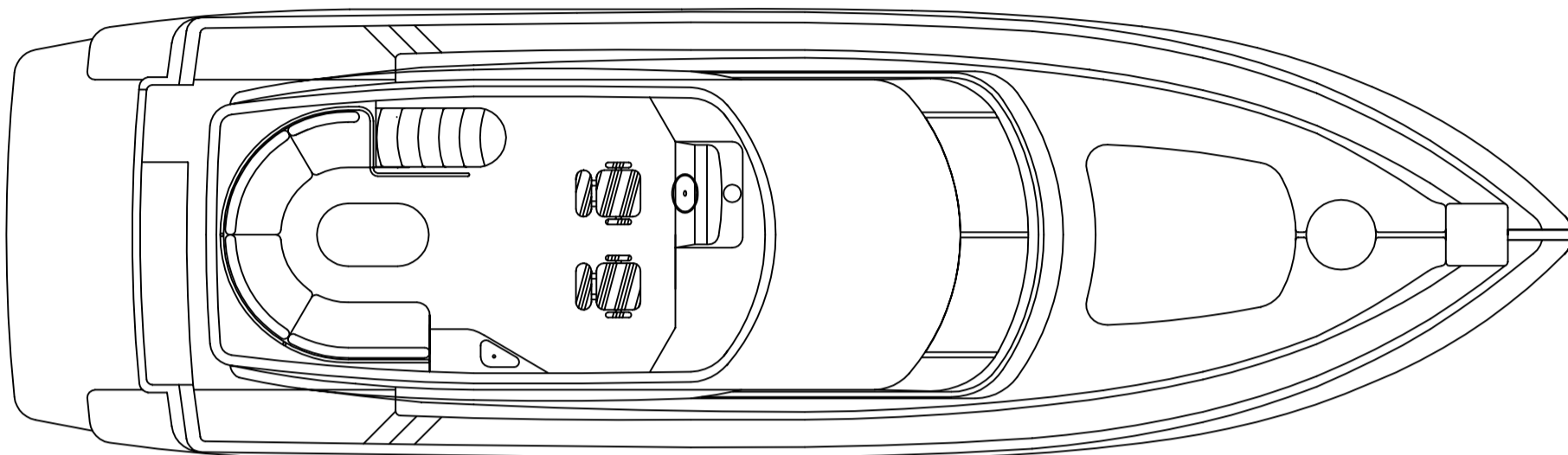

<b>Dyna 51'</b> General Layout	BOAT NO. Type A	DW'G NO D51G01-A	SCALE 3/16":1'	DATE 2007/08/23	DW'N BY Linjs	DS' BY	VERIFY
-----------------------------------	--------------------	---------------------	-------------------	--------------------	------------------	--------	--------